

FOR SALE or LEASE

7748 Madison Avenue, Indianapolis, IN 46227

PRICE REDUCED!



Southwood Professional Park

- 7,598 square feet total
- One story building with to-your-door parking
- Zoned C-1
- Lease rate: \$12.50/sf, net of janitorial and utilities
- Sale price: \$549,900



For more information, contact:

Darrin L. Boyd, SIOR, CCIM
317.590.8490
darrin.boyd@cassidyurley.com

David A. Moore, SIOR, CCIM
317.690.0617
david.moore@cassidyurley.com

6081 East 82nd Street, Suite 100
Indianapolis, Indiana 46250
Telephone 317.570.7000
Telefax 317.570.7010

www.IndyOfficeSpace.com

**Cassidy
Turley** | **Boyd • Moore**
IndyOfficeSpace.com

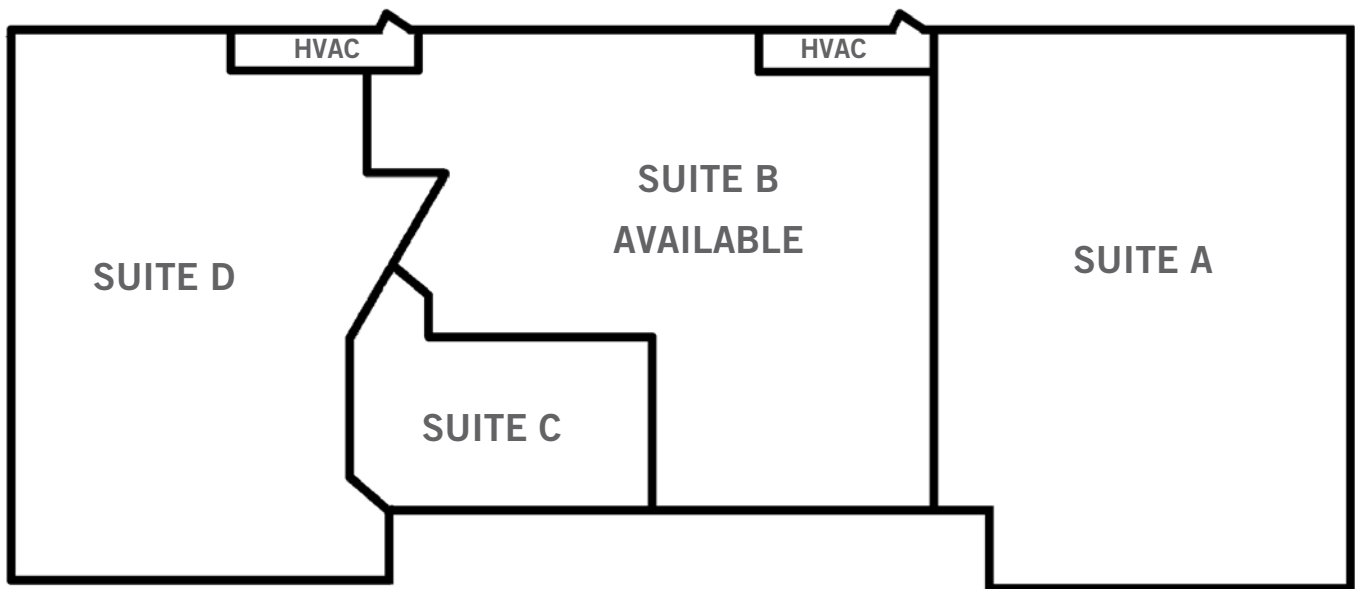

Southwood Professional Park
 7748 Madison Avenue
 Indianapolis, IN 46227
 7,598 SF



For more information, contact:

Darrin L. Boyd, SIOR, CCIM
 317.590.8490
 darrin.boyd@cassidyturley.com

David A. Moore, SIOR, CCIM
 317.690.0617
 david.moore@cassidyturley.com

6081 East 82nd Street, Suite 100
 Indianapolis, Indiana 46250
 Telephone 317.570.7000
 Telefax 317.570.7010

www.IndyOfficeSpace.com